

**BUILDING UPGRADES AND RENOVATIONS RECENTLY COMPLETED!**



### PROPERTY HIGHLIGHTS

**Beautifully designed professional office building available for lease, with new lobby and common area renovations recently completed.** Ideal location and buildout for users of all types: technology, software, law firms, engineering, finance, insurance, medical, real estate and other general/professional office users. Take advantage of high-quality existing buildout and additional extensive landlord work letters to customize your space. Join the large and growing professional Longmont community today!

Located along U.S. Highway 287, at the southern gateway to Longmont, the property enjoys convenient linkages to the Diagonal Highway between Longmont and Boulder. Interstate 25, located just 5-miles away, provides easy access to the greater Denver Metro area.

- **Traffic Counts of 25,000+ Per Day**
- **New Digital Monument Signage**
- **Expansive Front Range Views**
- **Tall/Open Ceilings**
- **Continuous UV-C Air Treatment**
- **NextLight Internet - Nation's Fastest**

### EXTENSIVE LANDLORD WORK LETTER AVAILABLE

<b>Rental Rate:</b>	\$18.00/SF NNN
<b>Available SF:</b>	Up to 16,053 SF Contiguous
<b>Date Available:</b>	Immediately
<b>Operating Expenses:</b>	\$9.75/SF (2022 est)

DISCLAIMER: The information contained in this brochure has been obtained from sources we believe to be reliable. However, while we have no reason to doubt the accuracy of the information, it is important for you to understand that we have not verified the accuracy or completeness of the information and, therefore, do not make any guarantees, warranties or representations regarding the accuracy and completeness of the information provided. It is your responsibility to verify and confirm the accuracy and completeness of the information contained herein. The tenant, buyer, seller and/or landlord should not rely on the information contained in this brochure but instead should independently verify the permitted use and zoning of the property him or herself. The zoning link is for initial informational purposes only.

### CONTACT US

**Ashley Overton**  
Broker Associate  
303.449.2131 ext 147  
ashley@coloradogroup.com

**Maureen Espinoza**  
Broker Associate  
303.449.2131 ext 123  
maureen@coloradogroup.com

**The Colorado Group, Inc**  
3434 47th St, Suite 220  
Boulder, CO 80301  
303.449.2131  
www.coloradogroup.com

# CLASS A OFFICE SPACE FOR LEASE

## LONGMONT PROFESSIONAL CAMPUS

Colorado  
Group

1551 PROFESSIONAL LANE, LONGMONT, CO 80501

### PROPERTY - PHOTOS



The Colorado Group, Inc. | 3434 47th St, Suite 220, Boulder, CO 80301 | 303-449-2131 | [www.coloradogroup.com](http://www.coloradogroup.com)

\* For a complete disclaimer, please see page one of this brochure.

# CLASS A OFFICE SPACE FOR LEASE

## LONGMONT PROFESSIONAL CAMPUS



1551 PROFESSIONAL LANE, LONGMONT, CO 80501

### PROPERTY FLOOR PLAN - **FIRST FLOOR**

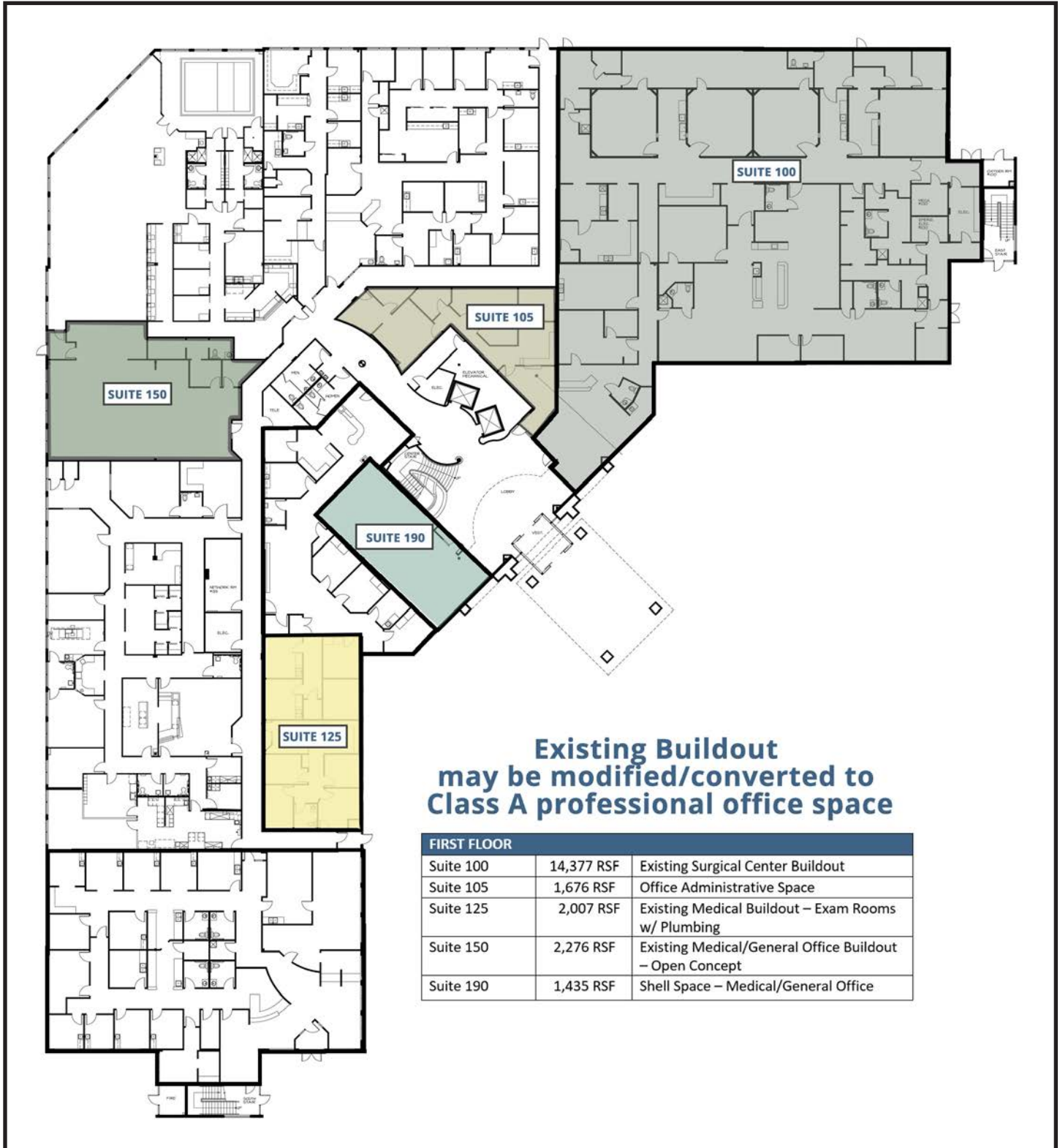

\* For a complete disclaimer, please see page one of this brochure.

# CLASS A OFFICE SPACE FOR LEASE

## LONGMONT PROFESSIONAL CAMPUS

Colorado  
Group

1551 PROFESSIONAL LANE, LONGMONT, CO 80501

PROPERTY FLOOR PLAN - **SECOND FLOOR**

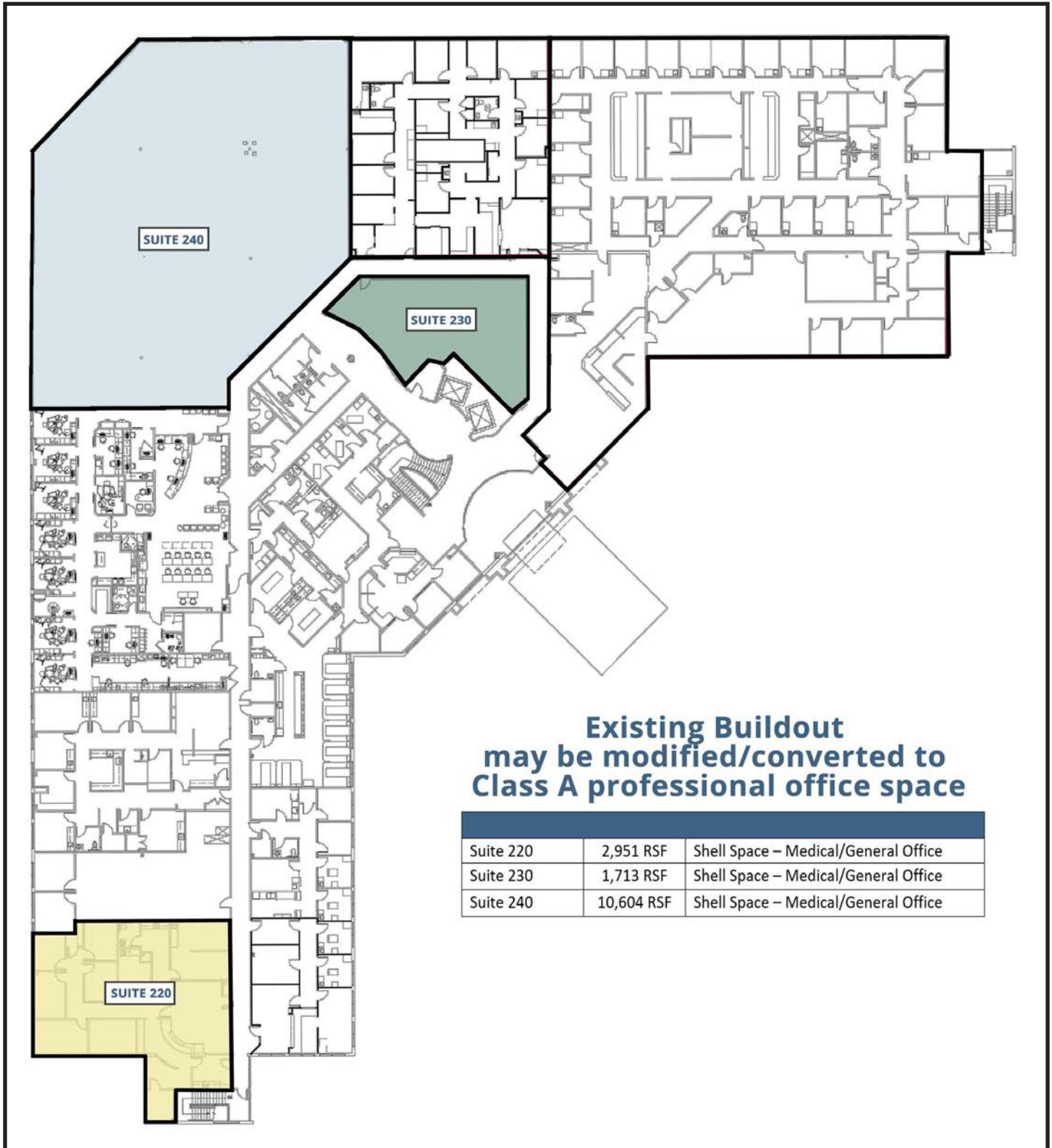

The Colorado Group, Inc. | 3434 47th St, Suite 220, Boulder, CO 80301 | 303-449-2131 | [www.coloradogroup.com](http://www.coloradogroup.com)

\* For a complete disclaimer, please see page one of this brochure.

# CLASS A OFFICE SPACE FOR LEASE LONGMONT PROFESSIONAL CAMPUS

Colorado  
Group

1551 PROFESSIONAL LANE, LONGMONT, CO 80501

## AMENITY MAP



## AREA MAP



The Colorado Group, Inc. | 3434 47th St, Suite 220, Boulder, CO 80301 | 303-449-2131 | [www.coloradogroup.com](http://www.coloradogroup.com)

\* For a complete disclaimer, please see page one of this brochure.